

Netherton Hub

Temporary traffic management on A950 – tree clearance works

Works are planned on a stretch of the A950 adjacent to Flushing near Longside in connection with the installation of a temporary roundabout at the Netherton Hub site access. The temporary roundabout will remain in place for the duration of construction. The scope of works will include roundabout construction, roadside ditch installation, pipe crossings, headwalls, bus stops, footpath construction and the creation of a temporary pond.

The timing of the roundabout installation is currently being planned for later this summer, subject to the relevant local authority approvals, and is expected to take approximately three months to complete. A more detailed programme for the installation, including associated traffic management, will be shared once it becomes available.

Associated tree clearance works

Enabling works are planned over the coming two weekends to facilitate the roundabout installation. These works will involve the felling of approximately 25 trees and associated vegetation clearance.

The removal of these trees is being accounted for in our biodiversity enhancement and management plan for the Hub, which will ensure that we achieve a significant biodiversity improvement overall compared to the current condition.

Traffic management

Please see the attached traffic management plan for the tree felling activities. Traffic lights will be in operation on **Saturday 30 May and possibly Saturday 6 June from 08:00 to 18:00**. Traffic management arrangements for the main roundabout works later this summer are still to be confirmed and will be communicated once finalised. A location map is shown overleaf.

Thank you

We would like to thank the local community for their understanding while these works are carried out. We apologise for any inconvenience or disruption this may cause, but these traffic management measures are necessary to help ensure the safety of both our workforce and all road users.

Project overview

Netherton Hub is a key component of SSEN Transmission's programme of grid upgrades across the north of Scotland. Located to the west of Peterhead near Longside, the Hub will contain 400kV and 132kV substations, converter stations for the Spittal to Peterhead, Eastern Green Link 3 and Eastern Green Link 5 subsea cable projects, a spares warehouse and operations base.

For more information

Contact our Community Liaison teams if you would like more information:

SSEN Transmission email: nethertonengagement@sse.com

Balfour Beatty email: nethertoncommunity@balfourbeatty.com

Stay up to date by signing up for project updates via our webpage:

Website www.ssen-transmission.co.uk/netherton-hub

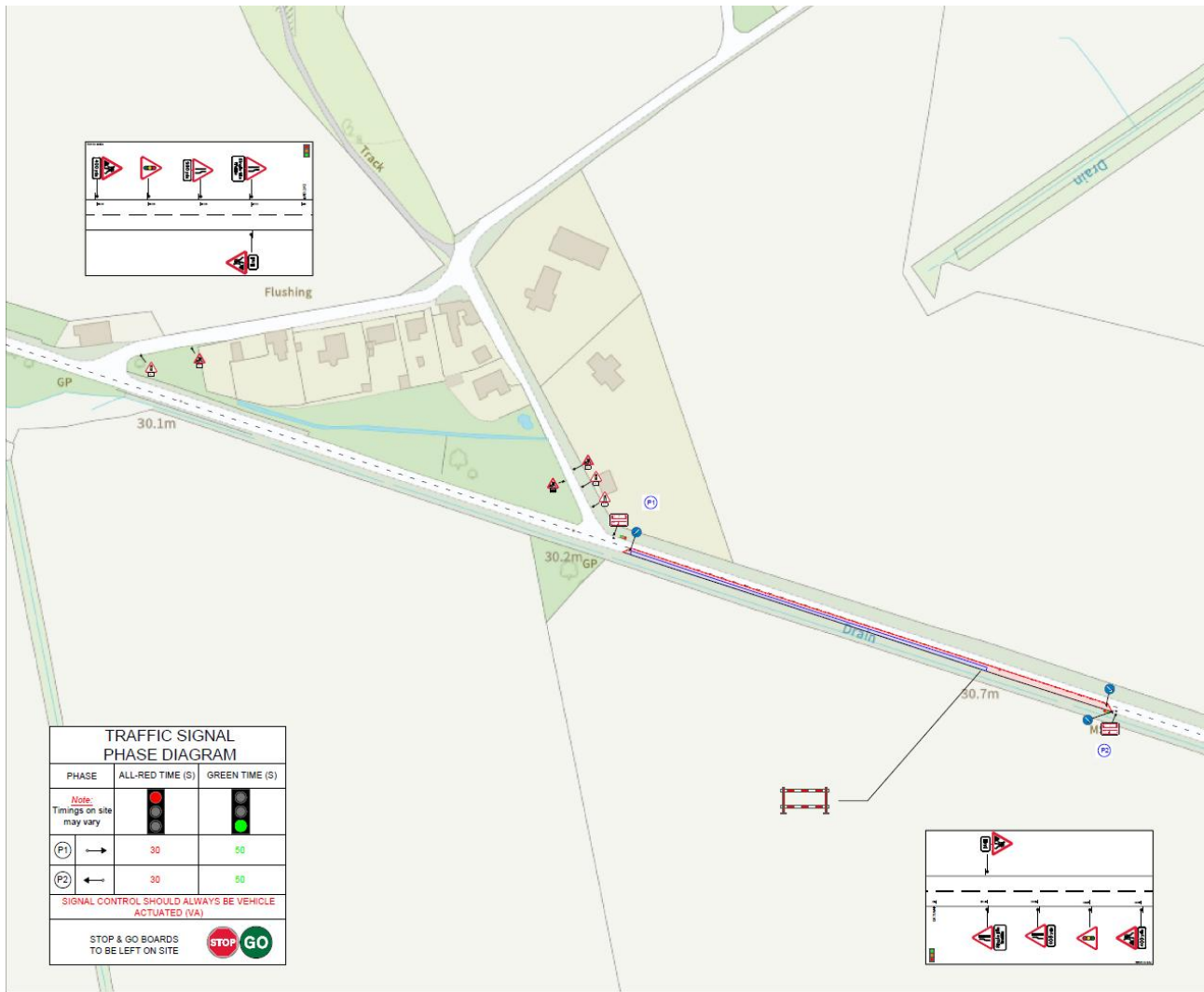

Figure 1 Location of proposed traffic management

